

\$765,000 - 172 Lewiston Drive Ne, Calgary

MLS® #A2198920

\$765,000

3 Bedroom, 3.00 Bathroom, 2,075 sqft

Residential on 0.07 Acres

Lewisburg, Calgary, Alberta

Welcome to the Capecastle, a stunning masterpiece by McKee Home, situated in the vibrant community of Lewiston. Thoughtfully designed for a growing family, this brand-new 2,00+ sq. ft. home offers an exceptional blend of space, style, and functionality.

Step inside to discover numerous upgrades throughout, enhancing the charm and sophistication of this residence. The main floor boasts an open-concept layout featuring a spacious living area, an elegant dining space, and a chef-inspired kitchen. A flex roomâ€”perfect as a home office or additional bedroomâ€”adds to the versatility of the design. With 9-foot ceilings, the space feels bright, airy, and inviting.

Upstairs, youâ€™ll find three generously sized bedrooms, including a luxurious primary suite and a central bonus roomâ€”ideal for family gatherings or a cozy retreat. With three bathrooms, this home ensures both comfort and convenience.

Backed by nearly 35 years of home-building expertise, the Capecastle is a testament to quality craftsmanship and thoughtful design. Donâ€™t miss this incredible opportunity to own a McKee Homes creation in the heart of Lewiston!



Built in 2024

Essential Information

MLS® #

A2198920

Price	\$765,000
Bedrooms	3
Bathrooms	3.00
Full Baths	3
Square Footage	2,075
Acres	0.07
Year Built	2024
Type	Residential
Sub-Type	Detached
Style	2 Storey
Status	Active

Community Information

Address	172 Lewiston Drive Ne
Subdivision	Lewisburg
City	Calgary
County	Calgary
Province	Alberta
Postal Code	T3P 2H9

Amenities

Parking Spaces	4
Parking	Double Garage Attached
# of Garages	2

Interior

Interior Features	Double Vanity, Kitchen Is Closet(s)
Appliances	Dishwasher, Electric Stove, Garage Control(s), Microwave, Range Hood, Refrigerator
Heating	Central
Cooling	None
Fireplace	Yes
# of Fireplaces	1
Fireplaces	Electric, Living Room
Has Basement	Yes
Basement	Exterior Entry, Full, Unfinished

Exterior

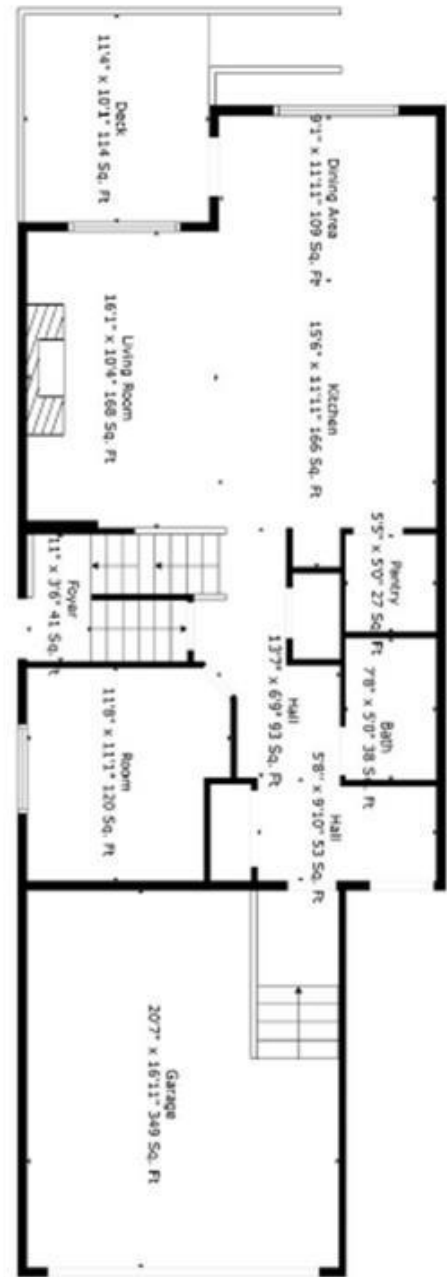

Exterior Features	None
Lot Description	Back Yard, Zero Lot Line
Roof	Asphalt Shingle
Construction	Vinyl Siding
Foundation	Poured Concrete

Additional Information

Date Listed	March 21st, 2025
Days on Market	26
Zoning	R-G

Listing Details

Listing Office	Manor Real Estate Ltd.
----------------	------------------------

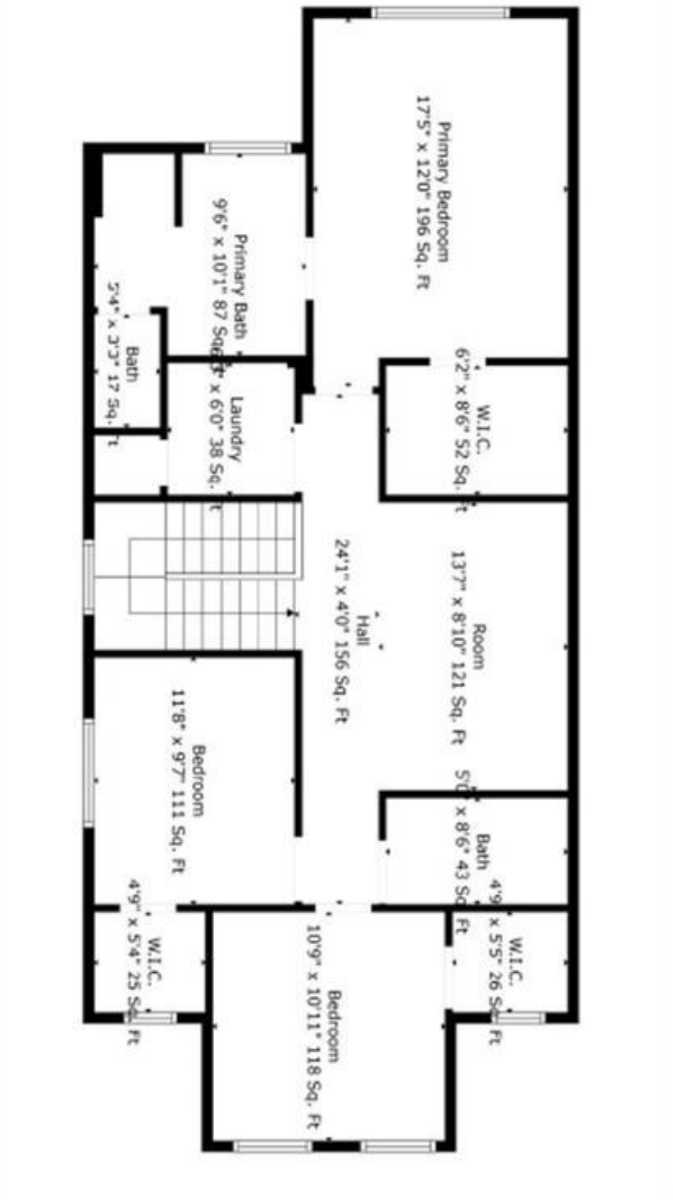

Data is supplied by Pillar 9â„¢ MLSÂ® System. Pillar 9â„¢ is the owner of the copyright in its MLSÂ® System. Data is deemed reliable but is not guaranteed accurate by Pillar 9â„¢. The trademarks MLSÂ®, Multiple Listing ServiceÂ® and the associated logos are owned by The Canadian Real Estate Association (CREA) and identify the quality of services provided by real estate professionals who are members of CREA. Used under license.